

# LED Bollard II



## *Key benefits:*

- Reliable & Impact-resistant
- Easy installation
- Comfortable soft light and environment friendly



# Product Range & Features

## Dark Grey Housing (RAL 7043)



Neutral White  
4000K



Warm White  
3000K

- Long life time low power LED light source  
>25,000 hours, 70% lumen maintenance
- Proved integrated electronic driver  
Life time: >25,000 hours
- Proved IP65 and IK10  
Robustly designed through strict process control to ensure the IP65 protection and IK10 impact resistance through lifetime.

# Easy installation

- Sleek in design, with an integrated installation base for easy mounting
- Integrated driver makes sure installation is simple

Integral base plate  
with PG gland



# Comfortable soft light & environment friendly



- Low power LEDs to create nice light effect with and uniform appearance.

- White tube diffuser brings comfortable soft light with less glare.



- Environment friendly LED solution.  
No hazardous substances (no mercury, no lead) No UV, low attraction to insects.

# LED Bollard II

## Data sheet

Product type	BCP150 (0.5m height)	BCP151 (0.8 height)
Light Source	96 low power LEDs	
Light Color	Warm white (3000K), Neutral white (4000K)	
Lumens	WW: 300 lm NW: 400lm	
CRI	NW>75 WW>80	
Optic	Closed, diffuser	
Optic cover	Poly carbonate diffuser board	
System power	8W	
Driver	220-240V / 50-60Hz, integrated (non-dimmable)	
Electrical class	Class I	
Degree of protection/impact resistance	IP65 / IK10	
Resistance to heat and fire	GWT= 850°C for plastics parts	
Mains cabling	Via 1 x M16 cable gland accepting cable 3 core x >1.0mm <sup>2</sup>	
Connection	Push in connector in 3 poles accepting wires 3core x >1.0mm <sup>2</sup>	
Material	Housing: Extrusion Aluminum; Diffuser Tube: Poly carbonate	
Color	Dark grey (RAL 7043),	
Operating temperature	-20°C < Ta < 40°C	
Lifetime	25,000 hours 70% lumen maintenance	
Installation	On ground surface mounting	
Weight	1.32 Kg (0.5m) , 1.85 Kg (0.8m)	
Dimensions (mm)	Ø100 x H 500	Ø100 x H 800
Test House-marks	CCC, CE and RoHS compliance	

# LED Bollard II

## Configuration & Dimensions

Product description

Model	Light Source	Color Temp	Driver	Voltage	Color
BCP150 (0.5m height)	LED150 lm	WW (3000K)	PSU (integrated)	220-240V	RAL7043
BCP151 (0.8m height)		NW (4000K)			

BCP150 LED150/WW PSU 220-240V 7043	BCP150	LED150	WW	PSU	220-240	7043
BCP150 LED150/NW PSU 220-240V 7043	BCP150	LED150	NW	PSU	220-240	7043
BCP151 LED150/WW PSU 220-240V 7043	BCP151	LED150	WW	PSU	220-240	7043
BCP151 LED150/NW PSU 220-240V 7043	BCP151	LED150	NW	PSU	220-240	7043

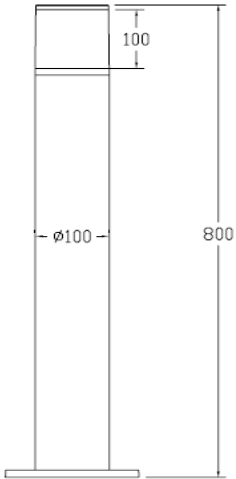
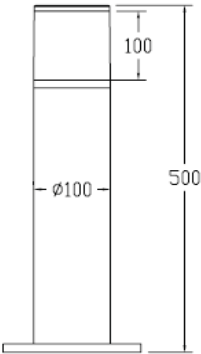
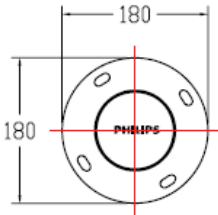

mm

## LED Bollard II

### Mounting instructions

#### LED Bollard II / LED 草坪灯

##### BCP150

Mounting instruction 安装说明

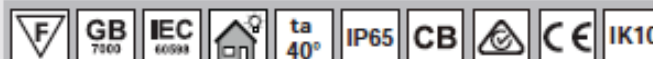

Type Number 产品型号	LEDs 灯珠数	Power 功率	Voltage 电压	Frequency 频率	Color Temperature 色温	Height 高度 (mm)	
BCP150 LED150WW PSU	96	8W	220-240V	50/60 Hz	3000 K	500	1.78
BCP150 LED150NW PSU	96	8W	220-240V	50/60 Hz	4000 K	500	1.78
BCP151 LED150WW PSU	96	8W	220-240V	50/60 Hz	3000 K	800	2.47
BCP151 LED150NW PSU	96	8W	220-240V	50/60 Hz	4000 K	800	2.47

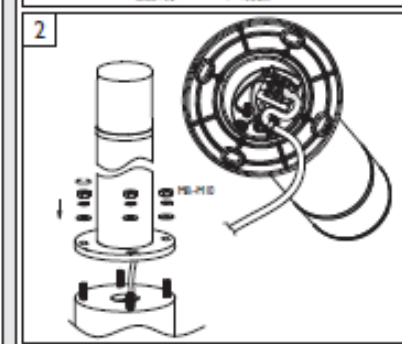
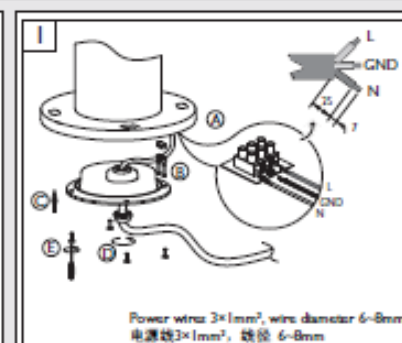
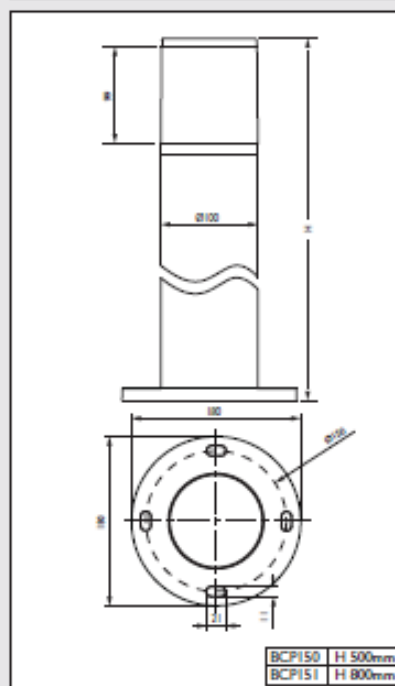

- The luminaire shall be installed by a qualified electrician and wired in accordance with the latest IEE electrical regulations or the national requirements.  
灯具应由有资质的电工安装。接线应符合IEE电气标准或国家标准。
- The luminaire shall, under no circumstance, be covered with thermal insulation matting or similar material.  
灯具不能被隔热或类似材料覆盖。
- Do not switch on before complete installation.  
接线过程中，切勿通电。

Philips Lighting Luminaire (Shanghai) Co., Ltd.  
Address: No. 2688, Huai Road, Jiaxing Shanghai, China  
Postal Code: 201800  
飞利浦照明(上海)有限公司  
地址: 中国上海市嘉定区马陆镇沪宜公路2688号  
邮编: 201800

# PHILIPS