

CityCube Family

Lighting solutions for Park & Plaza

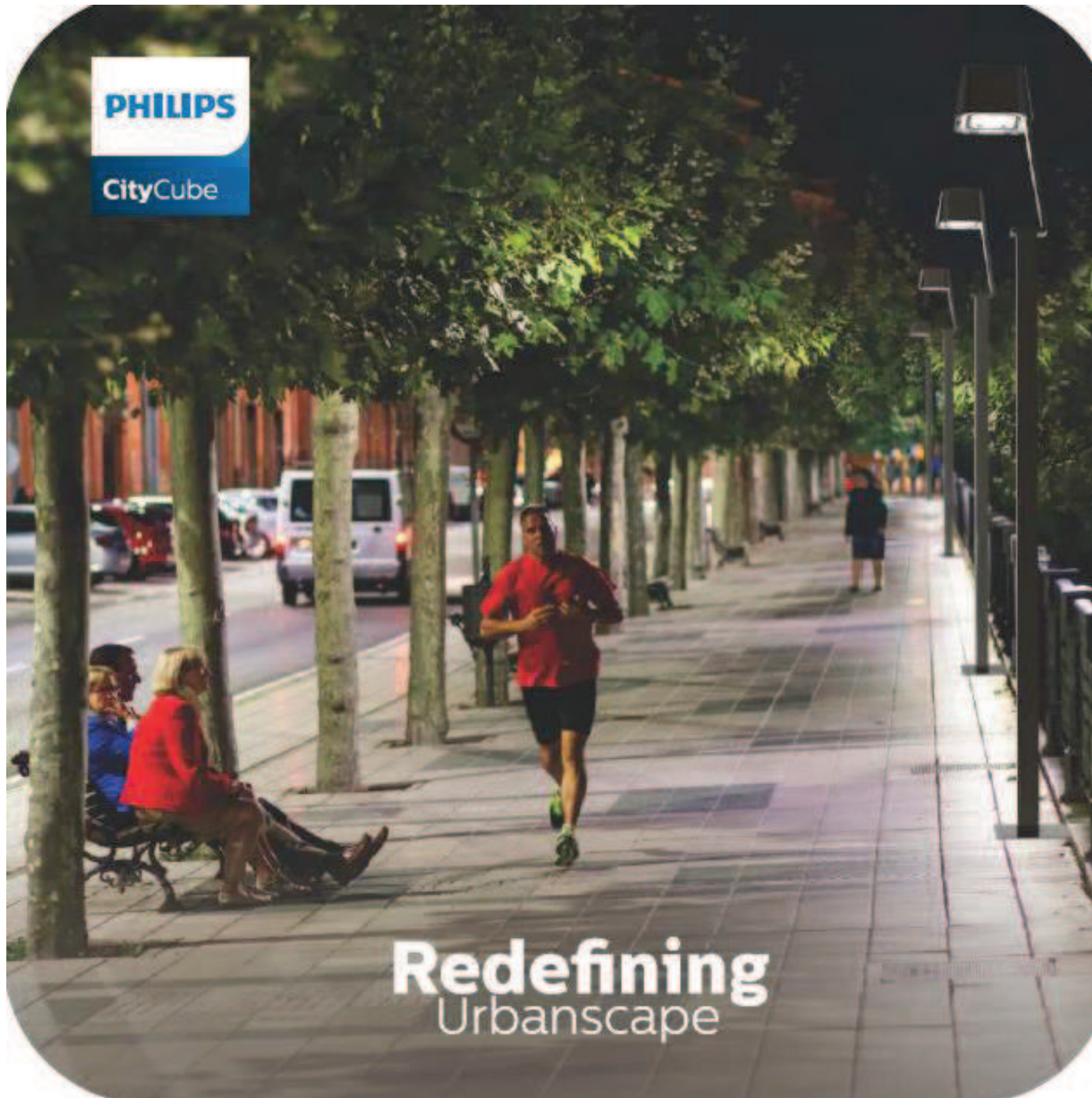

What Customers are expecting



**Aesthetics
Look & Feel**



**Economic
Optimization**



**Reliable Quality
Outdoor application**

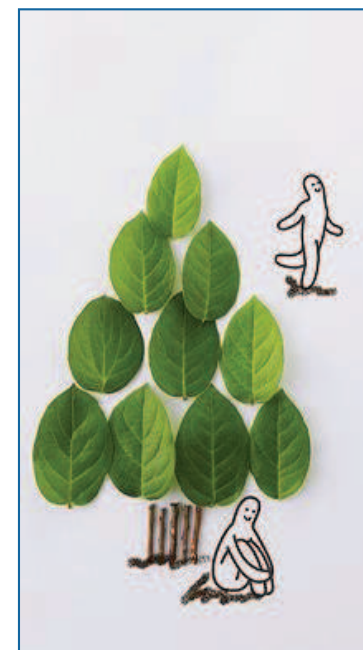

**Environment
Friendly**

CityCube Family Overview



Post Top Options

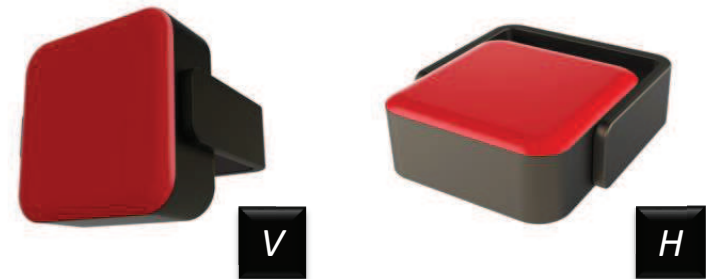

Wall Mount Options

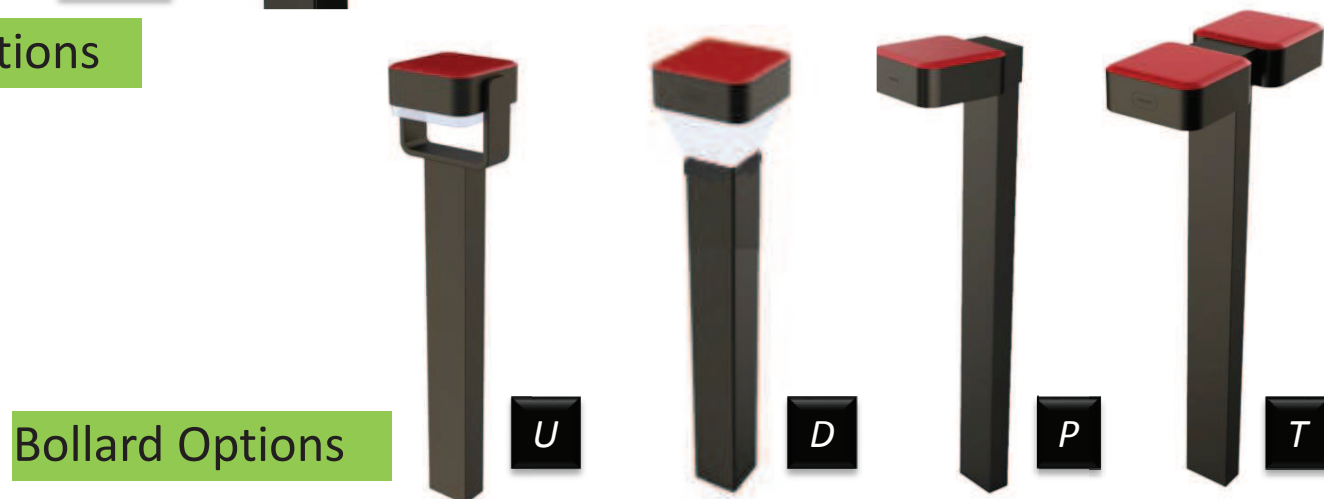

Bollard Options

Applications

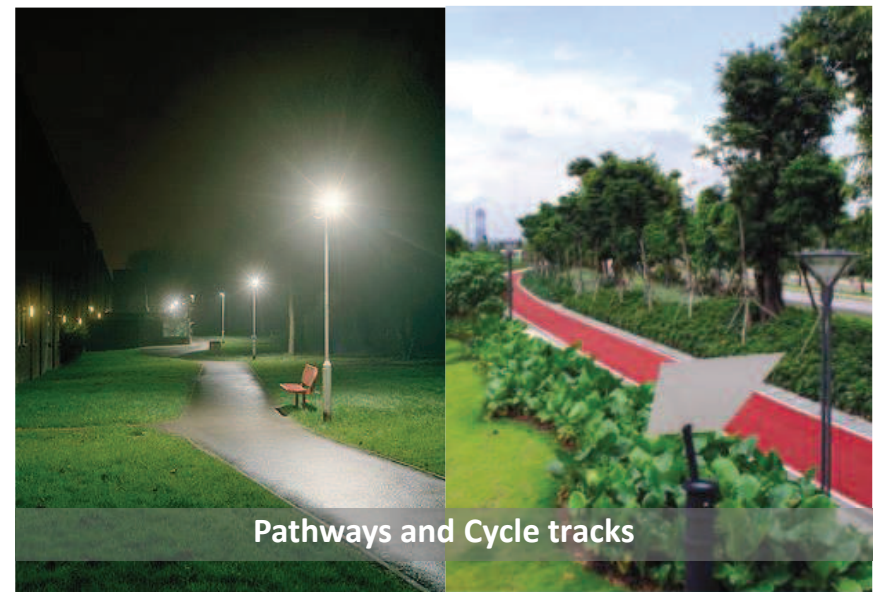

Key Specifications : Bollard

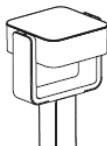
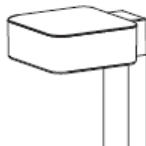
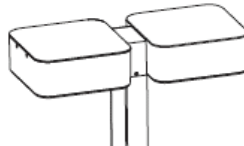
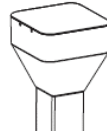
Parameter	SPECIFICATIONS			
Type	BCP400 LED04 U CW	BCP400 LED05 P CW	BCP400 LED09 T CW	BCP400 LED09 D CW
Image				
Lumen output	400lm	500lm	900lm	
CRI	70			
CCT	6500			
Optic	Symmetric			
Input voltage	140 - 270V			
Safety Class	Class I			
Power Factor	0.95			
System Power	8.5W	8.5W	17W	14W
System Efficacy	45lm/W	56lm/W	53lm/W	64lm/W
Housing material	LM6 Pressure Die cast Al.			
Diffuser material	PC			
IP	IP65			
IK	IK10			
Mounting	Wall Bracket			
Dimension (L x B x H)	177 x 210 x 700	177 x 215 x 700	177 x 395 x 700	177 x 177 x 700
Operating temperature	0°C to +50°C			
Lifetime	50K hrs @L70 @35°C			
Certification	IEC 60598			

Tolerance limitation : ±10%

Key Specifications : Wall mount

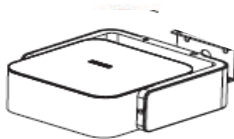
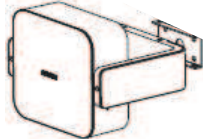
Parameter	SPECIFICATIONS	
Type	BWS400 LED05 H CW	BWS400 LED05 V CW
Image		
Lumen output	500lm	
CRI	70	
CCT	6500	
Optic	Symmetric	
Input voltage	140 - 270V	
Safety Class	Class I	
Power Factor	0.95	
System Power	8.5W	
System Efficacy	59lm/W	
Housing material	LM6 Pressure Die cast Al.	
Diffuser material	PC	
IP	IP65	
IK	IK10	
Mounting	Wall Bracket	
Dimension (L x B x H)	225 x 210 x 72	175 x 210 x 177
Operating temperature	0°C to +50°C	
Lifetime	50K hrs @L70 @35°C	
Certification	IEC 60598	

Tolerance limitation : ± 10%

Mounting Instruction : Wall mount

WALL LIGHT

Installation Instruction

Philips
Lighting

Wall Mounting

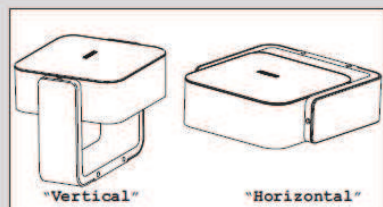

TYPE : BWS400
LAMP : LED
VOLTAGE : 240 V, 50 Hz
IP CLASSIFICATION : IP 65
NET WEIGHT : 3 Kg.
MAX. PROJECTED AREA : 0.03 m²
CCT : 6500 K
APPLICATION : WALL LIGHT



Dimensions

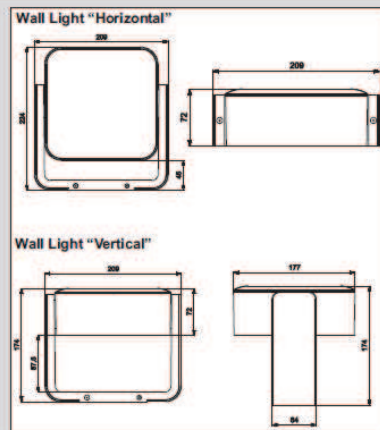

Outdoor Luminaire

PHILIPS

Easy to Install with mounting plate

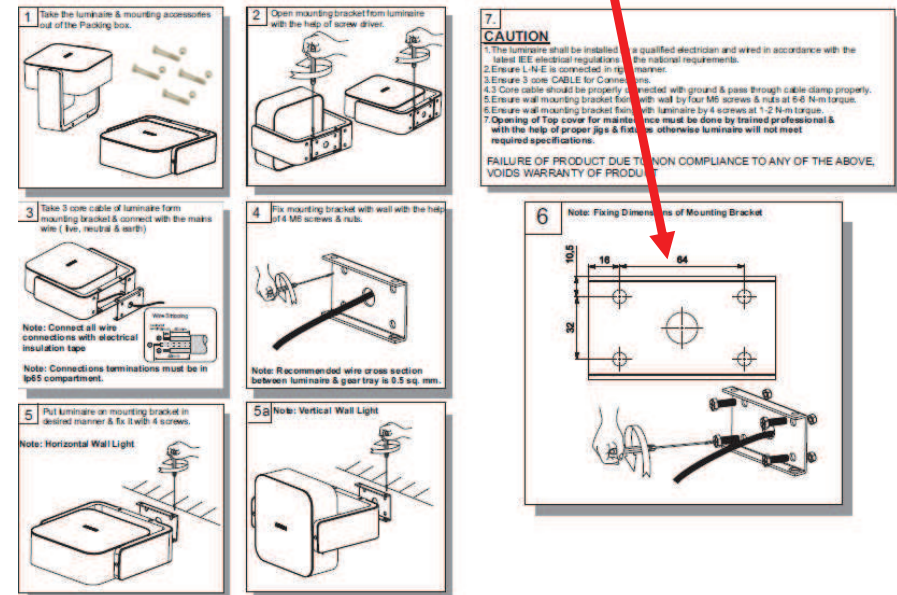

Mounting Instruction : Bollard

Bollard

Installation Instruction

Philips
Lighting

Pole Mounting

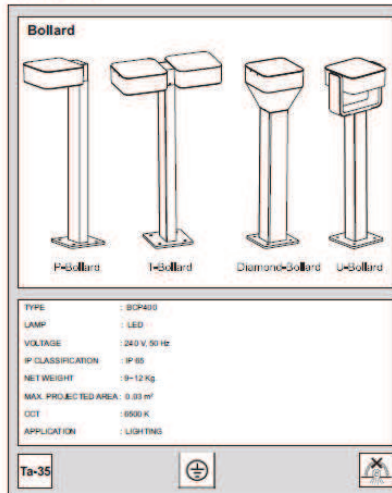

Dimensions

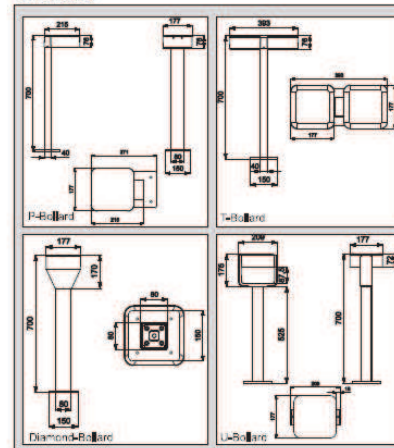

Outdoor Luminaire

Easy to Install with Baseplate

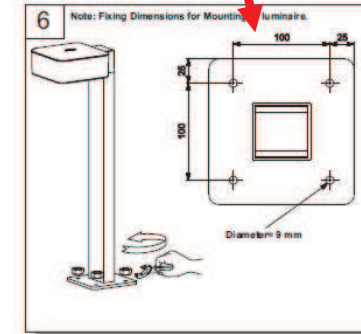
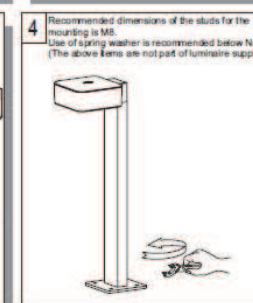
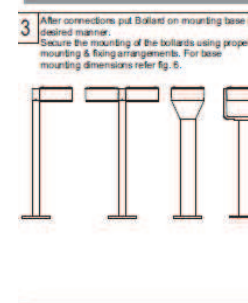
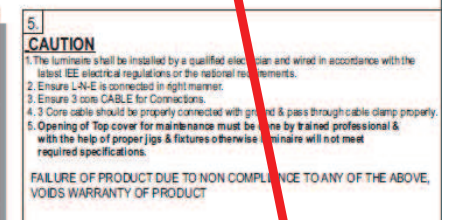
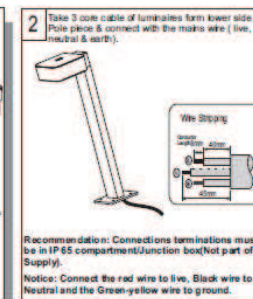
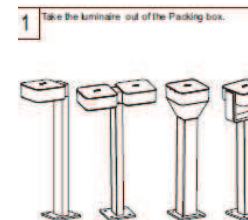

Caution : Earthing terminal to be connected

Installation

1. Connect the red wire to live, Black wire to Neutral and the Green-yellow wire to ground. After joining Properly insulate the wires using good quality Electrical insulation tape.

CAUTION

1. Ensure Earthing is connected.
2. Ensure 3 core CABLE for Connections(diameter 8-10mm)
3. Cable Entry gland should be properly tightened.
4. Product should be operated between 100-300V a.c.
5. Use Surge protection (upto 10kV) to protect against surges
Use Type B+C surge type SPD in distribution box to arrest switching and lighting surges.

FAILURE OF PRODUCT DUE TO NON COMPLIANCE TO ANY OF THE ABOVE,
VOIDS WARRANTY OF PRODUCT

- 6 Make the electrical connections in 3 pole connectors as per the L-N-E marking.

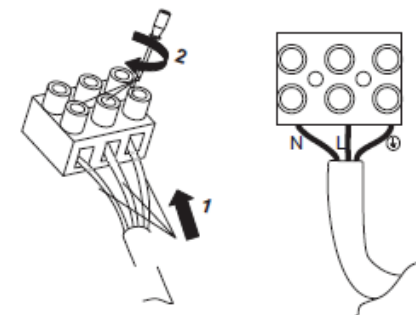

- Earthing is a must for all LED based product
- Ensure Surge protector, Voltage regulators are installed in the supply panel
- Ensure LED products are in a separate circuit and not connected with other heavy duty loads
- The warranty will be void if earthing is not provided as per applicable standards



